



D-DMEV

Continuous Decentralised Mechanical Ventilation Unit

Installation Instructions

1.0 SAFETY INFORMATION

- The device should not be used for applications other than those specified in this manual.
- After removing the product from its packaging, verify its condition. In case of doubt, contact a qualified technician. Do not leave packaging within the reach of small children or people with disabilities.
- Do not touch the appliance with wet or damp hands/feet.
- This appliance can be used by children aged from 8 years and above and persons with reduced physical, sensory or mental capabilities or lack of experience and knowledge if they have been given supervision or instruction concerning use of the appliance in a safe way and understand the hazards involved. Children shall not play with the appliance.
- Cleaning and user maintenance shall not be made by children without supervision.
- Do not use the product in the presence of inflammable vapours, such as alcohol, insecticides, gasoline, etc.
- If any abnormalities in operation are detected, disconnect the device from the mains supply and contact a qualified technician immediately. Use original spare parts only for repairs.
- The electrical system to which the device is connected must comply with regulations.
- Before connecting the product to the power supply or the power outlet, ensure that:
 - The data plate (voltage and frequency) corresponds to those of the electrical mains.
 - The electrical power supply/socket is adequate for maximum device power. If not, contact a qualified technician.
- The device should not be used as an activator for water heaters, stoves, etc., nor should it discharge into hot air/fume vent ducts deriving from any type of combustion unit. It must expel air outside via its own special duct.
- Operating temperature: 0°C up to +50°C.
- The device is designed to extract clean air only i.e., without grease, soot, chemical or corrosive agents, or flammable or explosive mixtures.
- Do not leave the device exposed to atmospheric agents (rain, sun, snow, etc.).
- Do not immerse the device or its parts in water or other liquids.
- Turn off the main switch whenever a malfunction is detected or when cleaning.

- For installation an omnipolar switch should be incorporated in the fixed wiring, in accordance with the wiring regulations, to provide a full disconnection under overvoltage category III conditions (contact opening distance equal to or greater than 3mm).
- If the supply cord is damaged, it must be replaced by the manufacturer, its service agent, or similarly qualified persons to avoid a hazard.
- Do not obstruct the fan or exhaust grille to ensure optimum air passage.
- Ensure adequate air return into the room in compliance with existing regulations to ensure proper device operation.
- If the environment in which the product is installed also houses a fuel-operating device (water heater, methane stove etc., that is not a “sealed chamber” type), it is essential to ensure adequate air intake, to ensure good combustion and proper equipment operation.
- Install the product so that the impeller is not accessible from the air outlet side as verified by contact with the Test Finger (test probe “B” of the norm EN61032) in compliance with the current safety regulations.

• Ceiling Installation

To guarantee the IPX4 degree of protection against moisture in case of ceiling installation, use the appropriate ceiling mount kit, which is not included. Use only the rear entry hole for supply cables. If there is a possibility of condensation along the air discharge duct, provide a drainage system to prevent condensation from discharging into the environment through the fan

Attention: do not mount the product on the ceiling without this kit.

• Window Installation

In case of window installation, it is necessary to use the appropriate window kit, which is not included. **Attention: do not mount the product on the window without this kit.**

1.1 Hazard Symbols



REFER TO INSTRUCTION MANUAL

Read and understand the installation and maintenance manual before installing, operating or maintaining this product.

1.2 Important Information

This manual contains important information on the safe and appropriate assembly, transport, commissioning, operation, maintenance, disassembly and simple troubleshooting of the product.

While the product has been manufactured according to the accepted rules of current technology, there is still a danger of personal injury or damage to equipment if the following general safety instructions and the warnings contained in these instructions are not complied with.

- **Read these instructions completely and thoroughly before working with the product.**
- **Keep these instructions in a location where they are accessible to all users at all times.**
- **Always include the operating instructions when you pass the product on to third parties.**

1.3 Personal Protective Equipment

The following minimum Personal Protective Equipment (PPE) is recommended when interacting with this product:

- **Protective Steel Toed Shoes** - when handling heavy objects.
- **Full Finger Gloves (Marigold PU800 or Equivalent)** - when handling sheet metal components.
- **Semi Fingerless Gloves (Marigold PU3000 3DO or Equivalent)** - when conducting light work on the unit requiring tactile dexterity.
- **Safety Glasses** - when conducting any cleaning/cutting operation or exchanging filters.
- **Reusable Half Mask Respirators** - when replacing filters which have been in contact with normal room or environmental air.

We would always recommend a site specific risk assessment by a competent person to determine if any additional PPE is required.

2.0 INTRODUCTION

This unit is a decentralised mechanical ventilation unit designed to ensure air extraction in small/medium-sized rooms.

Suitable for air discharge directly to the outside or in the presence of short ducted system. Wall, ceiling or window installation (Figures 1 - 6).

2.1 Technical Specifications

- Material: High quality, impact and UV-resistant ABS colour RAL 9010.
- Design front cover removable for cleaning without the use of tools.
- Rear reinforcement ring to prevent spigot deformation during installation.
- High efficiency aerodynamic fan with "winglet" blades to optimise quietness and efficiency.
- Single phase EC Brushless motor with integral thermal protection.
- Motor mounted on high quality ball bearings.
- The fan is double insulated: no earth connection is required.
- Trickle speed selectable during installation.
- Option to boost from trickle (or from off) through LS connection.
- Installation type selection available (through wall or ducted).
- IPX4 degree of protection.
- Power supply 220-240V~ 50Hz.

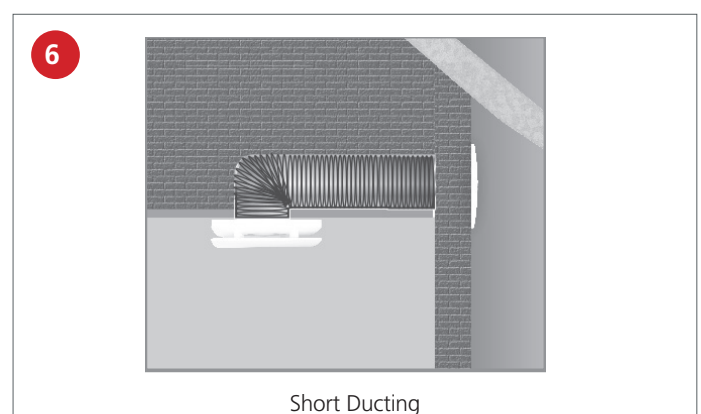
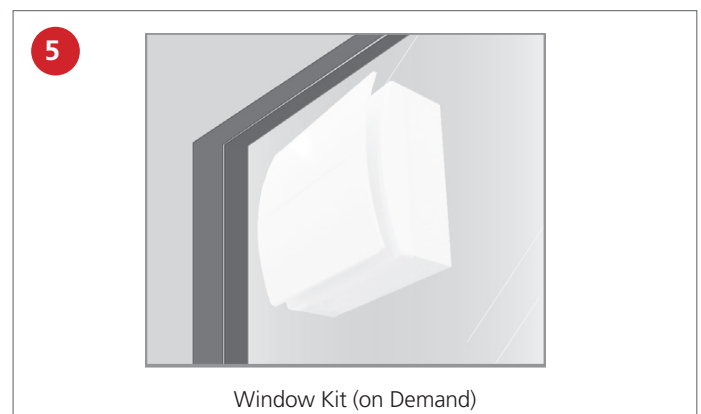
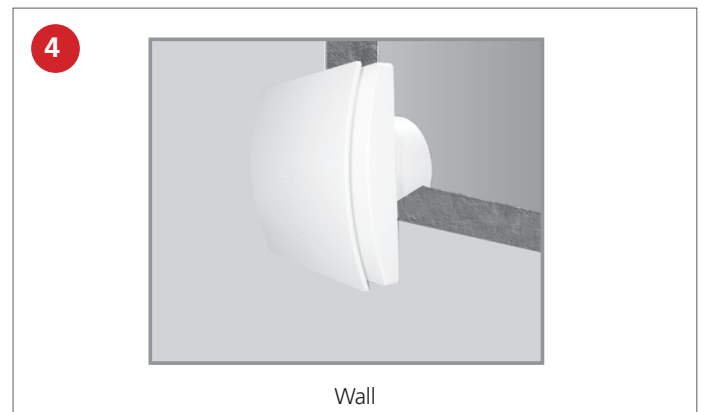
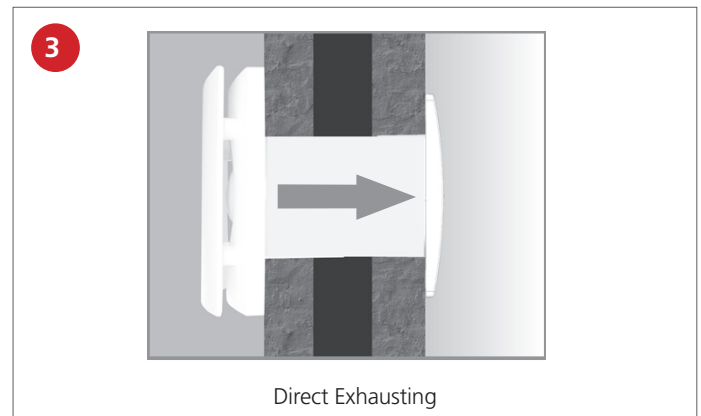
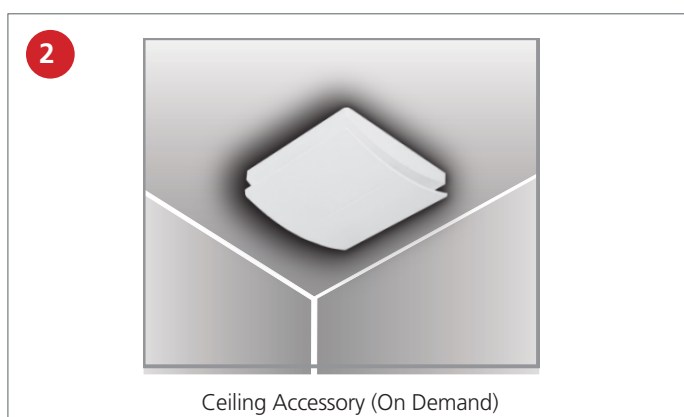
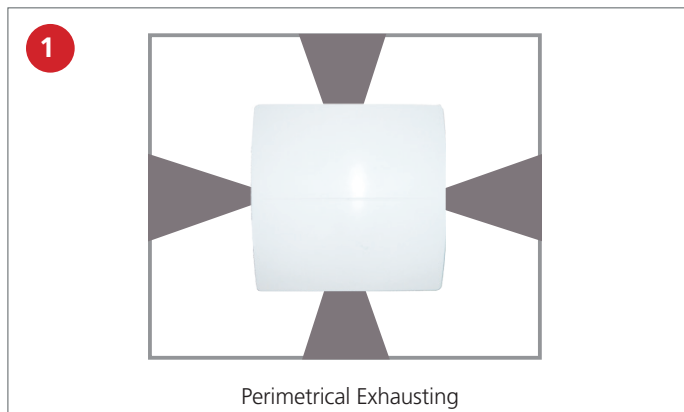

3.0 INSTALLATION

3.1 Dimensions

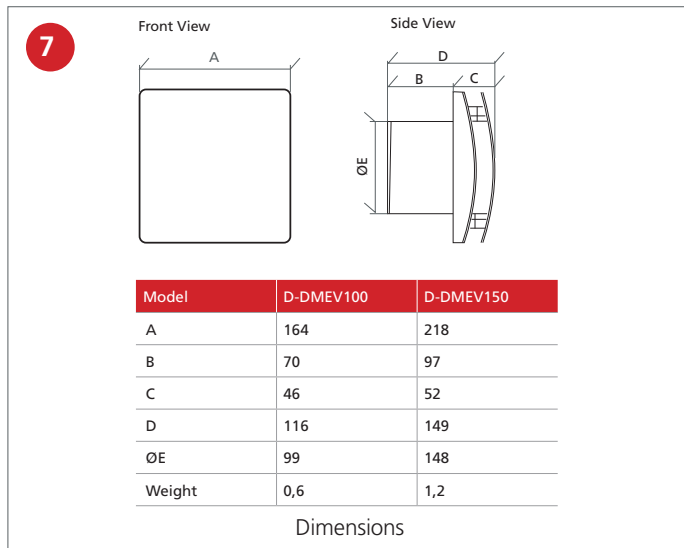

3.2 Installation Preparation

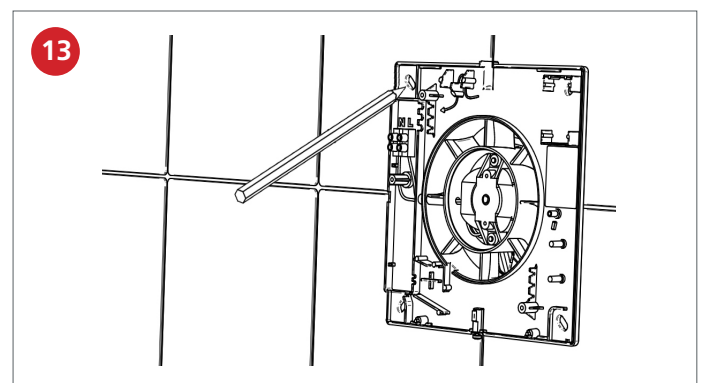
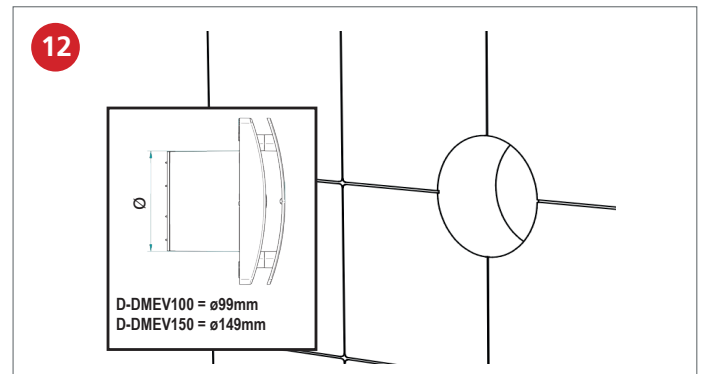
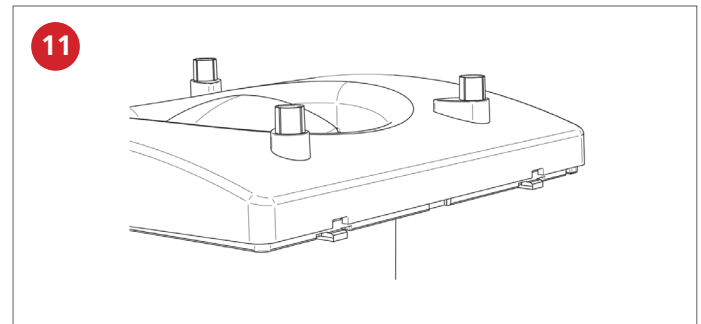
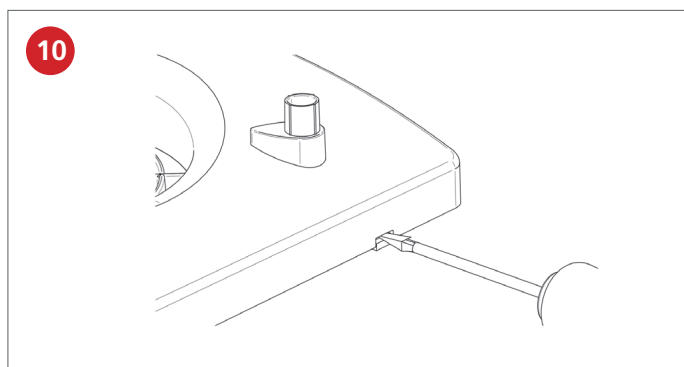
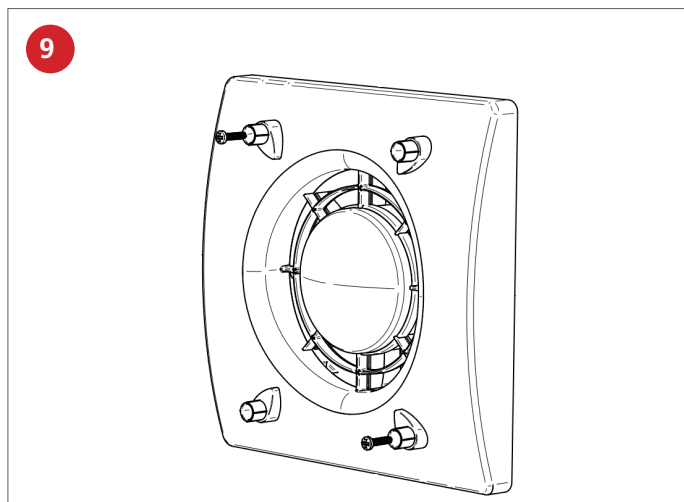
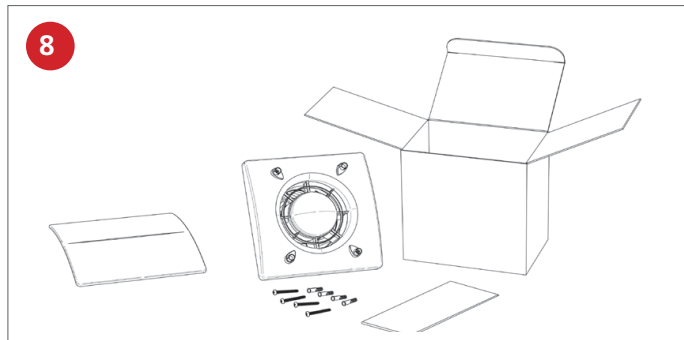

3.3 Surface Cable Installation

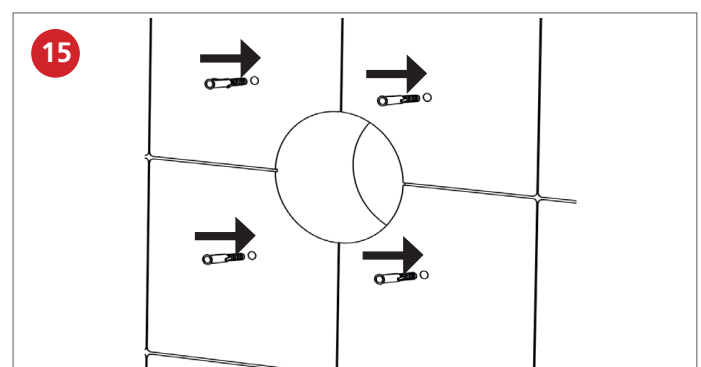
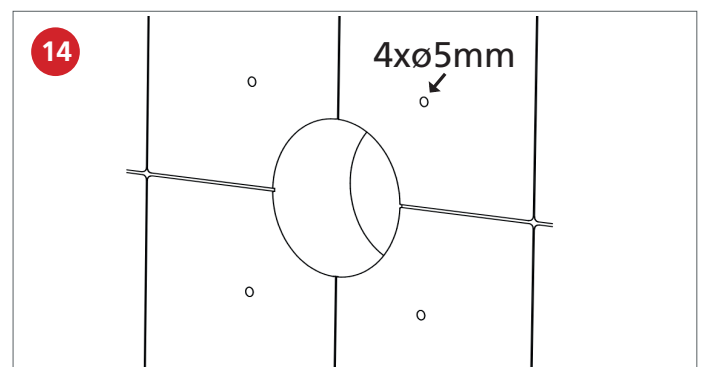

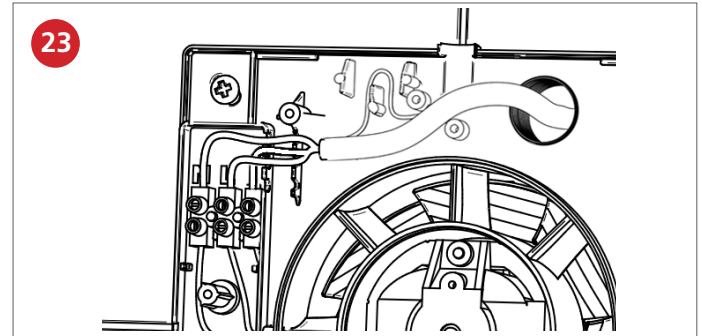
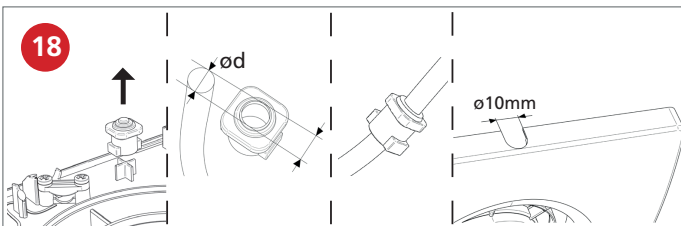
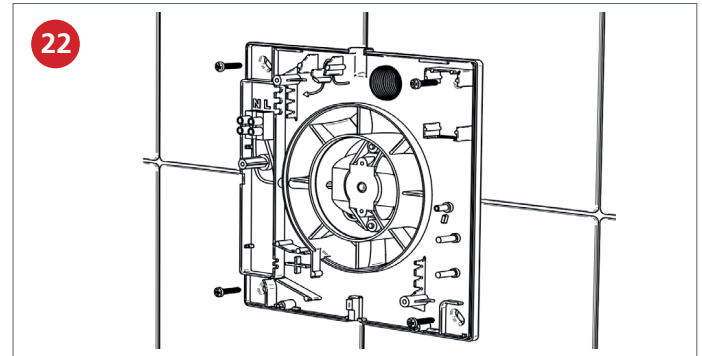
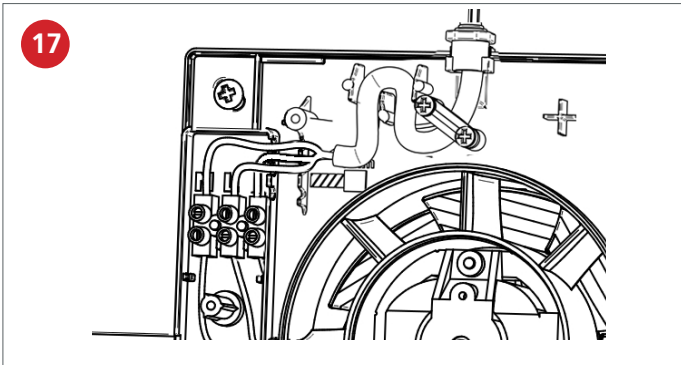
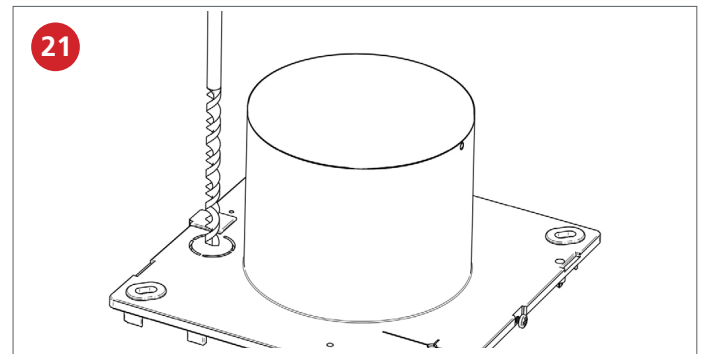
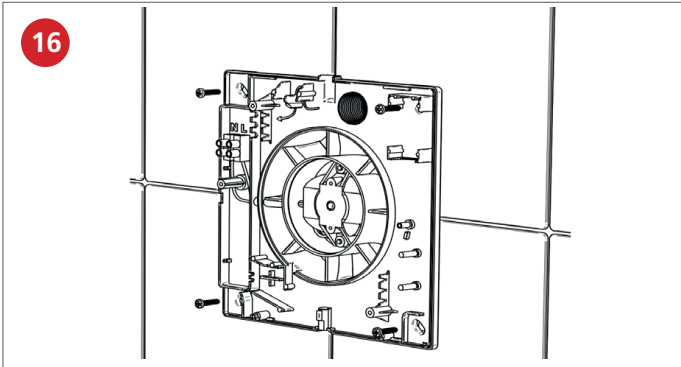

3.4 Recessed Cable Installation

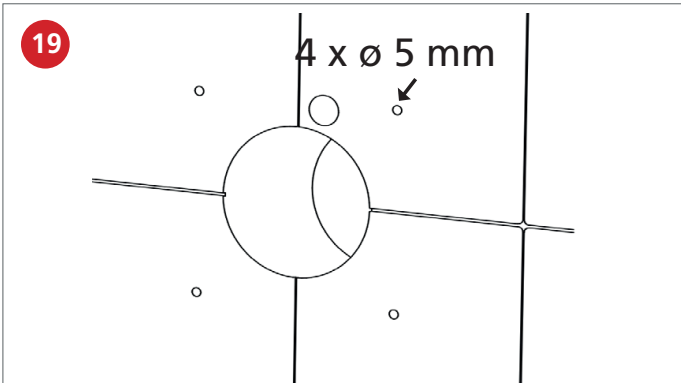

3.5 Electrical Cable Thickness

H03VV-F ; H05VV-F

BASE/STD:

2 x 0.5 / 1.5 mm²

3 x 0.5 / 1.5 mm²

HT:

3 x 0.5 / 1.5 mm²

4 x 0.5 / 1.5 mm²

3.6 Wiring Diagram

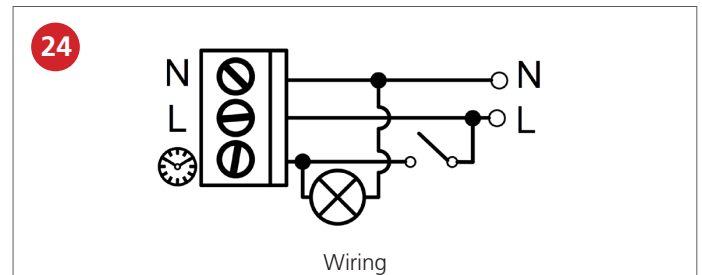

3.7 Installation Type Setting

Installation type can be selected using JUMPER 1 between the following options: through wall or ducted (Section 3.9).

3.8 Trickle Speed Setting

Trickle speed can be selected using JUMPER (Section 3.9).

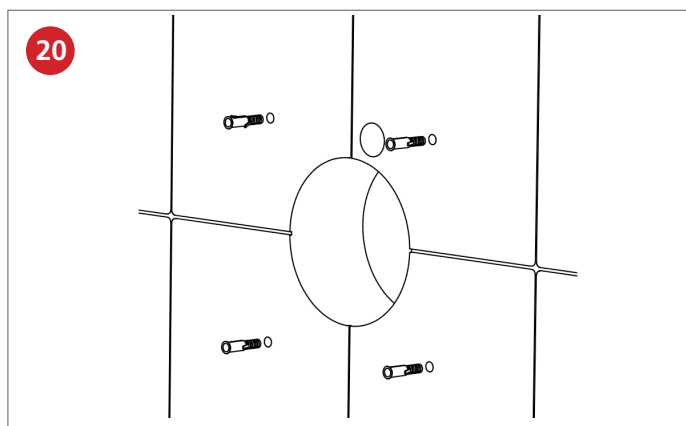

3.9 Jumper Settings

D-DMEV100				
JUMPERS			INSTALLATION	AIRFLOW
1	2	3		
		✓	Through Wall	6 l/s
	✓		Through Wall	8 l/s
	✓	✓	Through Wall	13 l/s
✓		✓	In Room	6 l/s
✓	✓		In Room	8 l/s
✓	✓	✓	In Room	13 l/s

D-DMEV150				
JUMPERS			INSTALLATION	AIRFLOW
1	2	3		
			Through Wall	6 l/s
		✓	Through Wall	8 l/s
	✓		Through Wall	13 l/s
	✓	✓	Through Wall	15 l/s
✓			Through Wall	17 l/s
✓		✓	Through Wall	21 l/s
✓	✓		Through Wall	25 l/s
✓	✓	✓	Through Wall	29 l/s

3.10 Humidity Sensor & Timer Settings

The fan is equipped with a humidity sensor, whose threshold is adjustable from 50% to 95% Relative Humidity via dedicated trimmer, and with a timer which is adjustable from 0 to approx. 30 minutes via dedicated trimmer (Figure 25).

The fan runs continuously at selected trickle speed (set by the jumper switch combination (Section 3.9), increases its speed in case the percentage of Relative Humidity exceeds the settable threshold, and can anyway be boosted with a dedicated ON/OFF switch (or PIR, CO2... sensor) or with a light switch (Figure 24). Trickle speed can be set to off (Section 3.9).

To deactivate the humidistat function, turn the trimmer HY completely clockwise.

Automatic humidistat operation: when the percentage of Relative Humidity exceeds the settable threshold, fan speed automatically increases to "comfort boost" speed, (intermediate between the selected trickle speed and the boost speed). When the percentage of Relative Humidity goes below the threshold, the fan continues to function at "comfort boost" speed for a factory set period of time then returns to selected trickle speed.

Operation with external switch: (Figure 24). When the external switch is turned on, the fan is boosted (max speed). After the external switch is turned off, the fan continues to run at boost speed for a settable period of time, then it returns to selected trickle speed (or to "comfort boost" speed in case automatic humidistat operation is on). The front cover LED indicates when the external switch is on.

The over-run timer function is activated only if the external switch has been on for at least 60 seconds.

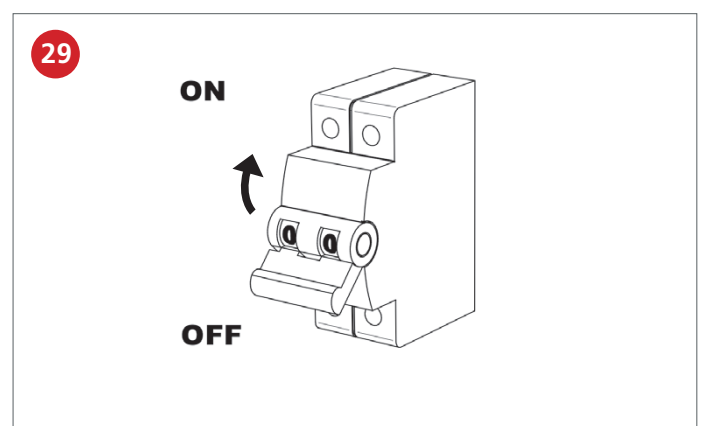
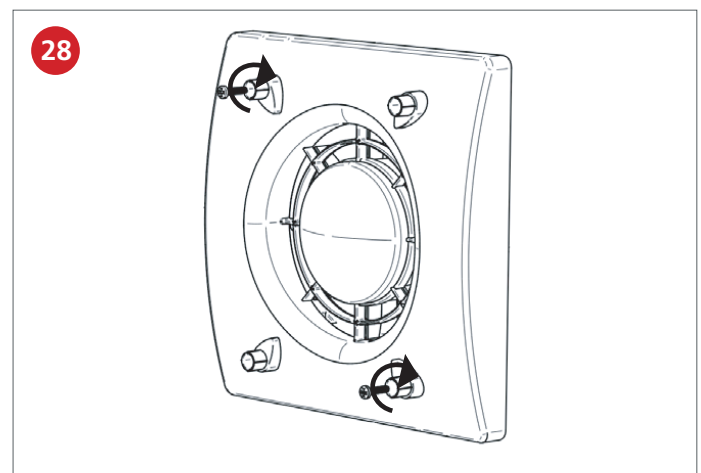
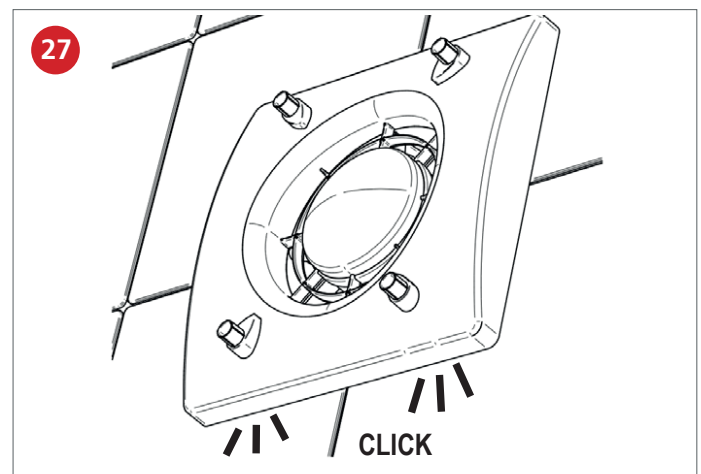
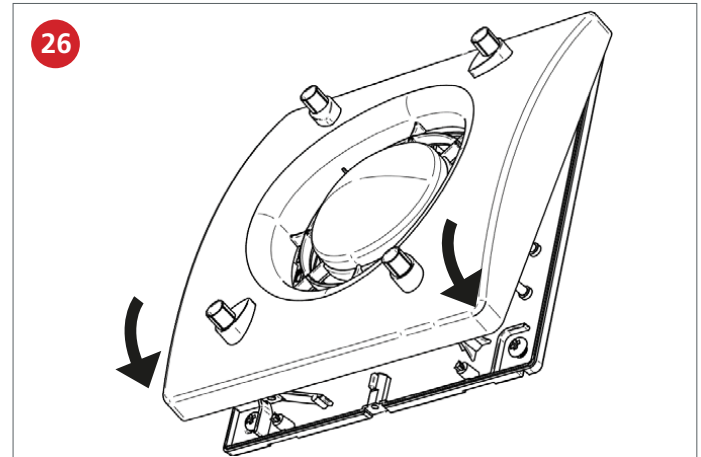
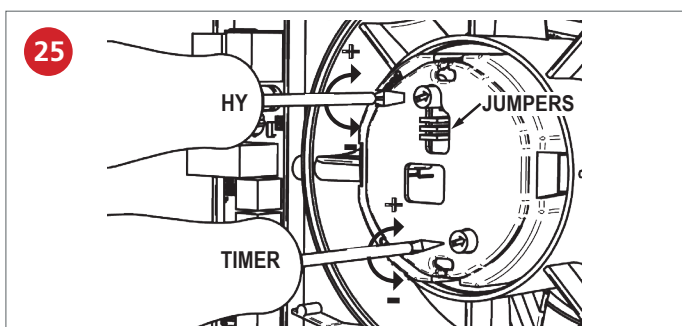

3.11 Installation Completion

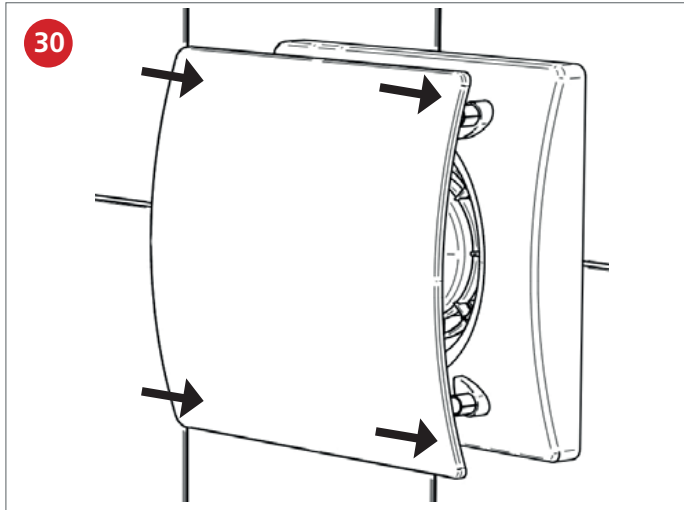

4.0 MAINTENANCE

It is important that maintenance checks are recorded and that the schedule is always adhered to, in all cases, the previous report should be referred to.

Before any maintenance or cleaning operation, switch off the fan and disconnect from the power supply.

4.1 Routine Maintenance

The magnetic front cover can be removed and cleaned with water and a mild detergent using a soft cloth and the motor fan assembly can be cleaned with a dry brush or dry cloth. Any other maintenance or cleaning should be carried out by properly qualified personnel.

Ensure the unit does not come into contact with any kind of liquid or solvent. If this should occur, contact a qualified technician before reassembling the fan.

The motor does not require lubrication as it is of the maintenance free "sealed for life" type.

5.0 WARRANTY

The 5 year warranty starts from the day of delivery and includes first year parts and labour, remaining year parts only. This warranty is void if the equipment is modified without authorisation, is incorrectly applied, misused, disassembled, or not installed, commissioned and maintained in accordance with the details contained in this manual and general good practice.

The product warranty applies to the UK mainland and in accordance with Clause 14 of our Conditions of Sale. Customers purchasing from outside of the UK should contact Domus Ventilation Sales office for further details.

Failure to maintain the unit as recommended will invalidate the warranty.

6.0 END-OF-LIFE AND RECYCLING

Where possible components which can be largely recycled when the product reaches its end-of-life have been used:

- Fans, motors, controls, actuators, cabling and other electrical components can be segregated into WEEE recycling streams.
- Sheet metal parts, aluminium extrusion, heating/cooling coils and other metallic items can be segregated and fully recycled.
- EPP, plastic ducting, nylon corner pieces, plastic heat exchangers, packaging material and other plastic components can be segregated into mixed plastic and widely recycled.
- Cardboard packaging, wood, and other paper components can be largely recycled or fully processed in energy from waste centres.
- Filter Disposal: Cardboard framed filters should be fully processed in energy from waste centres, contact your local civic amenity site / household waste recycling centre regarding metal / wire framed filters.
- Remaining Items can be further segregated and processed in accordance with the zero waste hierarchy. Please call After Sales Support for further information on items not listed above.

Ensure that this product is made safe from any electrical / water / refrigerant supplies before dismantling commences. This work should only be undertaken by a qualified person in accordance with local authority regulations and guidelines, taking into account all site based risks.

This product complies with EU Directive 2002/96/EC.

The symbol of the crossed-out dustbin indicates that this product must be collected separately from other waste at the end of its life. The user must, therefore, dispose of the product in question at suitable electronic and electro-technical waste disposal collection centres, or else send the product back to the retailer when purchasing a new, equivalent type device.

Separate collection of decommissioned equipment for recycling, treatment and environmentally compatible disposal helps to prevent negative effects on the environment and on health and promotes the recycling of the materials that make up the equipment.

Improper disposal of the product by the user may result in administrative sanctions as provided by law.



7.0 AFTER SALES AND REPLACEMENT PARTS

For technical assistance or further product information, including spare parts and replacement components, please contact the After Sales Department.

If ordering spares please quote the serial number of the unit together with the part number, if the part number is not known please give a full description of the part required. The serial number will be found on the identification plate attached to the unit casing.

Telephone 03443 715 523
vent.technical@domusventilation.co.uk

Technical or commercial considerations may, from time to time, make it necessary to alter the design, performance and dimensions of equipment and the right is reserved to make such changes without prior notice.

Domus Ventilation

Block C, Van Court, Caerphilly CF83 3ED, United Kingdom

Email: vent.info@domusventilation.co.uk

Tel: 03443 715 523

www.domusventilation.co.uk

